



## Ice Maker® Ball Valve

ISO EN 9001:2000



S-100-STN

### Description

1/4 turn, lever operated, hot forged brass ball valve. 100% full port. Blow-out proof two-piece design. Made in Italy. 100% tested.

### Features

- Pressure rating: 125 WOG
- Double Viton® O-rings
- Replaces non-code saddle valves
- Forged brass body
- 100% full port
- 1/4" side tap
- Hard C.P. brass ball

### Accessories

- "Lift-N-Lock" locking device
- 2" Handle extension
- Lever and Round 304 stainless steel handles
- "Slo-Ball" Handle (for metering under high pressures)
- Red Painted Aluminum "T" Handle
- Pneumatic & Electric Actuation Available upon request

### Warranty

The Company, for a period of one year from the date of shipment, warrants each product or system of its own manufacture to the original purchaser to be free from defects in material and workmanship under normal use, service and maintenance.

#### Architect/Engineer approval

Job Name \_\_\_\_\_ Date \_\_\_\_\_  
Model Specified \_\_\_\_\_ Quantity \_\_\_\_\_  
Variations Specified \_\_\_\_\_  
Customer/Wholesaler \_\_\_\_\_  
Contractor \_\_\_\_\_  
Architect \_\_\_\_\_

Note: Information subject to change without notice.



Jomar Valve  
7243 Miller Drive  
Warren, MI 48092  
Phone: 800-325-5690  
Fax: 800-628-4194  
www.jomarvalve.com

S-100-STN  
© Copyright 2010 Printed in U.S.A.  
0510

## Ice Maker® Ball Valve



### Description

1/4 turn, lever operated, hot forged brass ball valve. 100% full port. Blow-out proof two-piece design. Made in Italy. 100% tested.

### Dimensions In Inches

Computer Number	Valve Size	A	B	D	C	E	F	CV†
100-823	1/2"	2.48	1.53	0.59	.53	2.95	1.24	20.25
100-824	3/4"	3.26	1.88	0.79	.88	3.74	1.49	41.83
100-825	1"	3.93	2.36	1.00	2.36	4.72	1.97	78.38

† The CV Factor is the gallons of water per minute passed through the valve with 1 PSI pressure drop.

### Material Specification

No.	Part Name	Materials
1	Body	Hot Forged Brass
2	End Adapter	Hot Forged Brass
3	Ball	Hard C.P. Brass
4	Seat (2)	Hostaflon®- TFM 1600
5	Stem	Extruded Brass
6	Stem Packing	Hostaflon®- TFM 1600
7	Stem O-Rings (2)	Viton®
8	Packing Gland	Extruded Brass
9	Flat Washer	BUNA-N
10	Cap	Extruded Brass
11	Lever handle	Plastic coated steel
12	Handle Nut	Dacromet Coated Steel

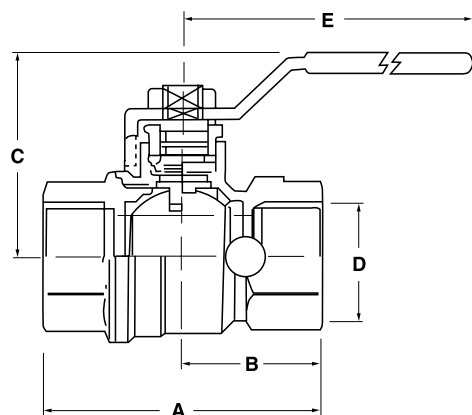

Valve Seat Rating

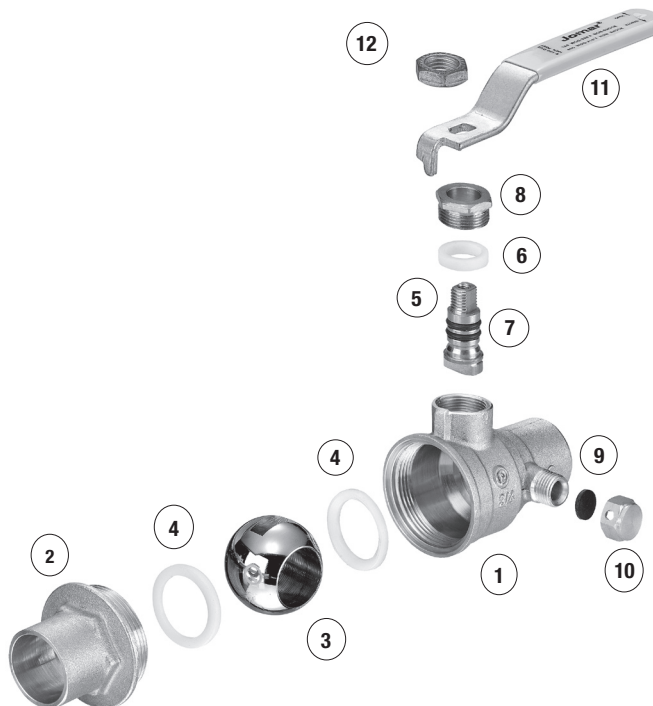
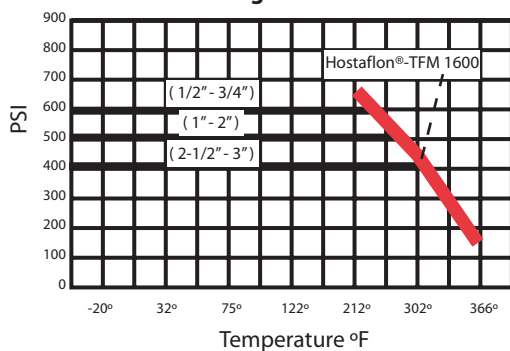

Note: Information subject to change without notice.



Jomar Valve  
7243 Miller Drive  
Warren, MI 48092  
Phone: 800-325-5690  
Fax: 800-628-4194  
www.jomarvalve.com

© Copyright 2010 Printed in U.S.A.  
0510